

Junction **25**

conference & meeting venue

Communication, Connection, Promotion, Exhibition, Education & Function



West Yorkshire
WYMS
Manufacturing Services



Welcome to Junction 25



At Junction 25 the experience starts as you enter the building. Our foyer and plasma screens can be branded with your logo and display personalised welcome messages.

On entering our reception, our helpful and friendly staff will be on hand to answer any questions and deal with any technical queries you may have.

A variety of lunch options are available including light bites to full luncheon options, we pride ourselves on being able to cater for all.

Most rooms are equipped with digital projectors, air conditioning and free wifi is available throughout the venue.

Speak to one of our helpful customer service staff who will instantly be able to provide you with costs and availability information on 01484 711462 or email info@wyms.co.uk.

Excellent Facilities

Maintained to a high standard, Junction 25 has excellent facilities to ensure delegates have a pleasant day. These include:-

- Two minutes from M62, JCT25
- Ample free on-site parking
- 10 flexible rooms
- Air-conditioned
- Natural day light
- Cleaned and well presented
- Centre and room personalisation
- Free wifi

Having ramped access, wide corridors, a lift and disabled toilets on both floors you can be assured that Junction 25 caters for all.



Easy Booking

Making a booking couldn't be easier. Simply email info@wyms.co.uk or call us on 01484 711462 to speak to one of our helpful customer service staff who will instantly be able to provide you with costs and availability information.

Flexible Rooms



Whether you need a high-quality training environment, a conference venue or an off-site location for an important meeting, the flexibility of rooms within Junction 25 will surpass your needs.

Junction 25 offers 10 rooms with capacities ranging from 8 - 110 delegates. All rooms are air conditioned, offer natural light and feature a rail system with move-able dry wipe boards and flip charts, a fixed wall mounted screen and a data projector.

Add to this modern decoration, disability-compliant accessibility and friendly helpful staff and you have the perfect conference and meeting room location.

Many of our rooms can accommodate various layouts. We can offer flexible terms, whether you need a room for the day, half a day or just for an hour or two.

Room	Room Size (Width x Length)	Location	Room Capacities				
			"U" Shape	Boardroom	Classroom	Theatre	Cabaret
Kirkdale	7.7m x 13.2m	First Floor	30	30	60	110	60
Clifton	7.8m x 12.5m	First Floor	30	30	30	70	56
Colne	6.0m x 8.2m	Ground Floor	18	16	17	30	16
Calder	5.8m x 7.3m	First Floor	18	16	16	30	24
Victoria	5.8m x 7.3m	First Floor	18	16	16	30	24
Albany	5.8m x 7.3m	First Floor	18	16	16	30	24
Delph	4.8m x 8.2m	Ground Floor	16	N/A	N/A	N/A	N/A
Boardroom	3.5m x 6.0m	Ground Floor	N/A	13	N/A	N/A	N/A
Locksley	3.8m x 3.8m	First Floor	N/A	8	N/A	N/A	8
IT Suite	N/A	Ground Floor	N/A	N/A	12	N/A	N/A
EIC	N/A	Ground Floor	N/A	N/A	N/A	N/A	N/A

Room Information

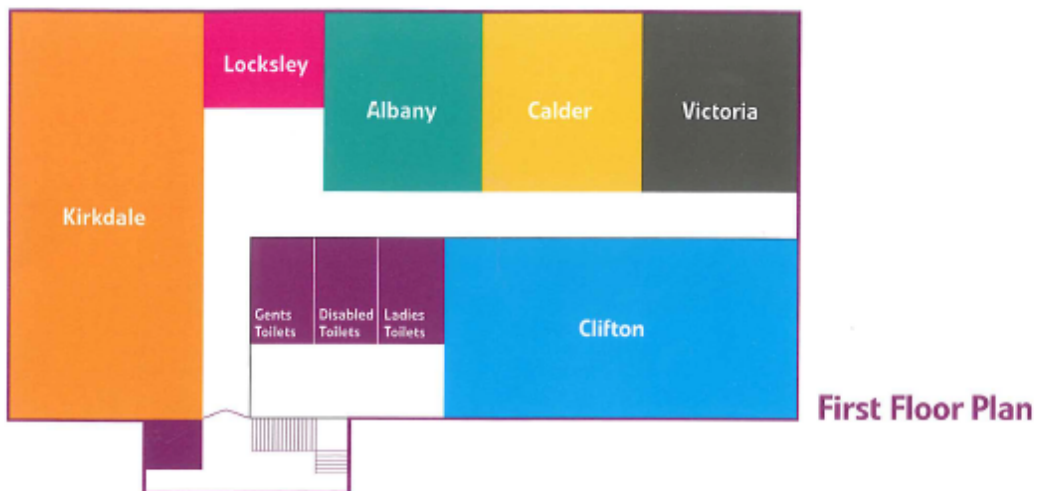

First Floor Plan

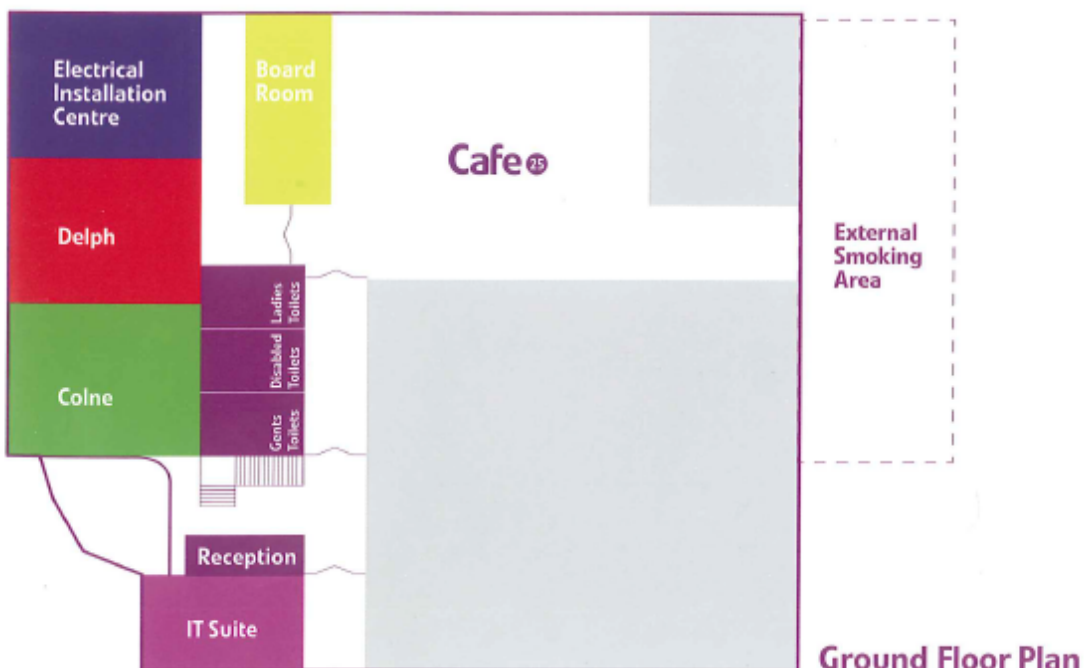

Ground Floor Plan

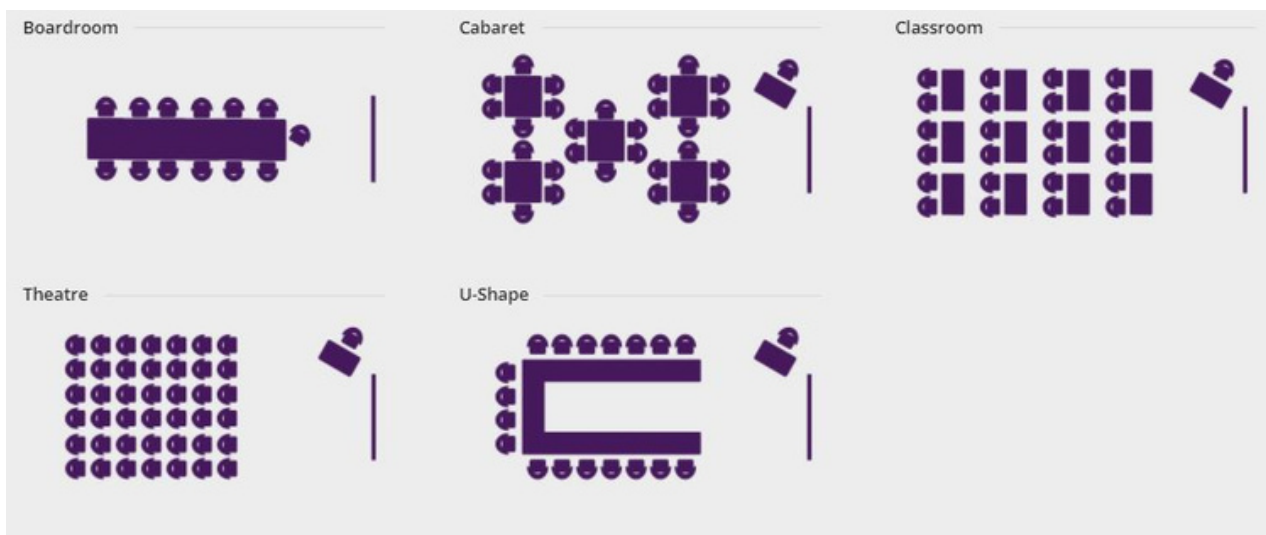

Gallery

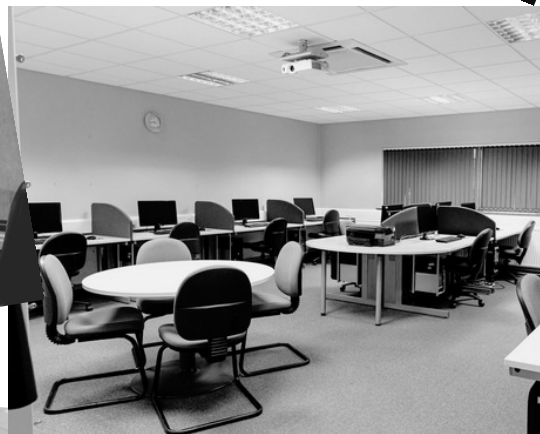

West Yorkshire
WYMS
Manufacturing Services